

Angle Top Shades

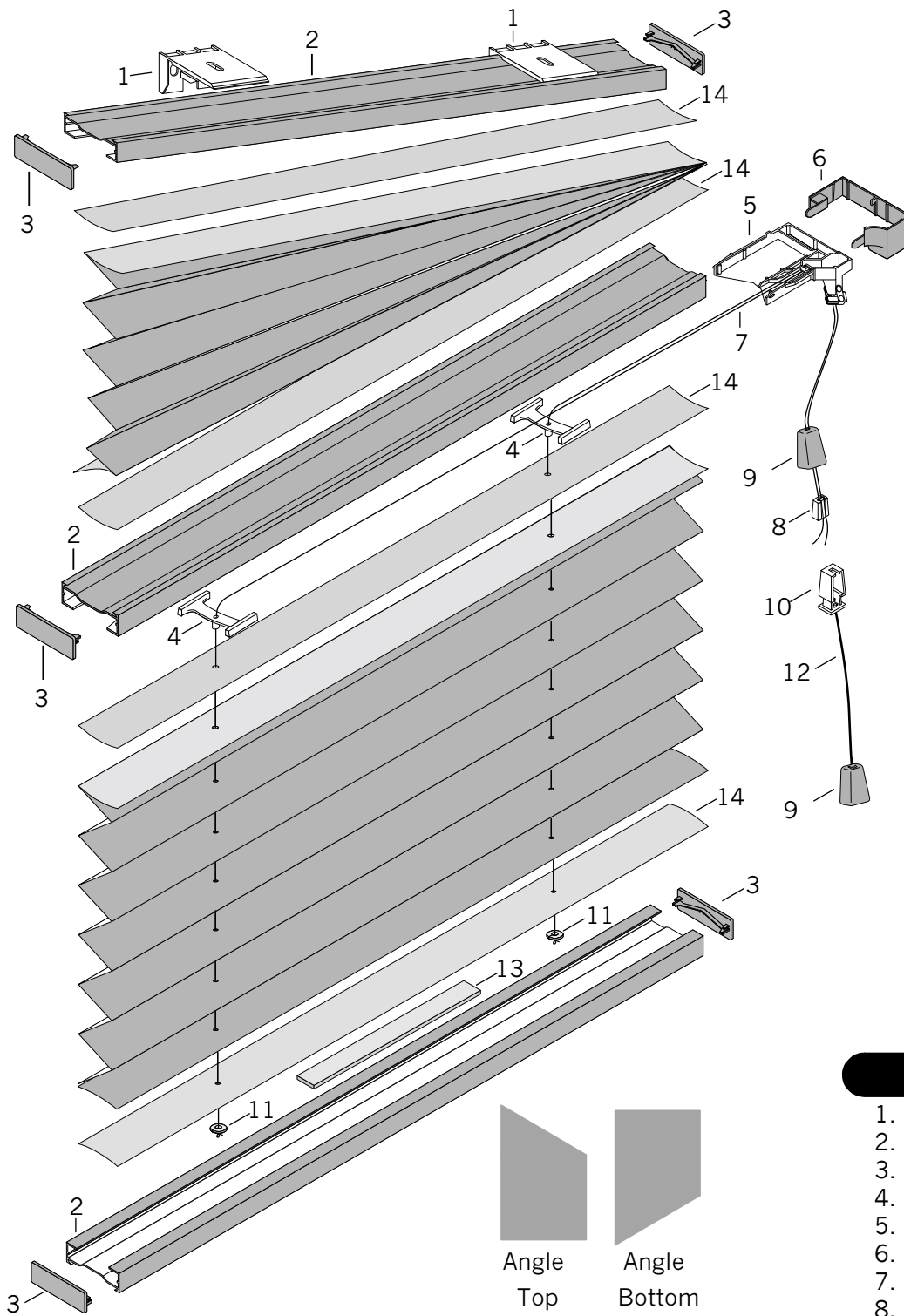

Standard Parts

1. Installation Brackets
2. Headrail/Bottomrail
3. End Caps
4. Cord Guide
5. Cordlock Body
6. Cordlock Cover
7. Lift Cord
8. Cord Equalizer
9. Universal Cover/Tassel
10. Equalizer Housing
11. Plastic Washer
12. Pull Cord
13. Rail Weight
14. Filler Strip

Angle Top Shades

No.	PCN	Description	Additional Components:	
1.	Installation Brackets		XSB101A72P	Room Darkening Backing
	PC555255	Installation Bracket - White (2 Pack)	XTW101A90P	Light Filtering Backing
	PC555256	Installation Bracket - White (3 Pack)	2980246000	Child Safety Kit
	2980038000	3/8" End Mount Clip	LIT888005	Speciality Installation Instructions (English)
2.	2950010xxx	Headrail/Bottomrail	LIT888005F	Speciality Installation Instructions (French)
3.	Headrail/Bottomrail End Caps		555004	Installation Screw
	5570xx		444956	Extension Brackets
	2950020xxx		5007311000	Hold-Down Bracket
4.	558000	Cord Guide	2930230000	Spacer Block
5.	Cordlock Body		555065	Tap
	2950095000	Left Hand	888105	Bottomrail Label (English)
	2950094000	Right Hand	7106858000	Bottomrail Label (French)
6.	Cordlock Cover – Left Hand		7107684000	Cord Stop Safety Hang Tag
	5560xx		x = Color Code	
	2950085xxx			
	Cordlock Cover – Right Hand			
	5560xx			
	2950075xxx			
7.	0.9 mm Lift Cord			
	5580xx			
	PC5580xx			
8.	559058	Cord Equalizer		
9.	2930440xxx	Universal Cover/Tassel		
10.	2930561000	Equalizer Housing		
11.	555019	Plastic Washers		
12.	1.8 mm Pull Cord			
	5580xx			
	PC5580xx			
	WWC5580xx			
13.	Rail Weight - Optional (*used only if needed)			
	PC5550003			
	PC5550006			
	PC55500012			
14.	2954000000	Filler Strip		