

# Specialty Shades

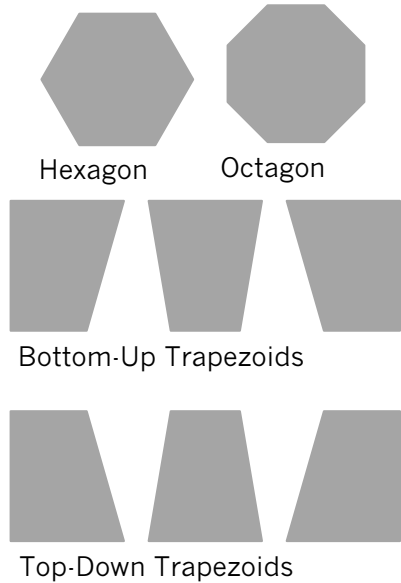
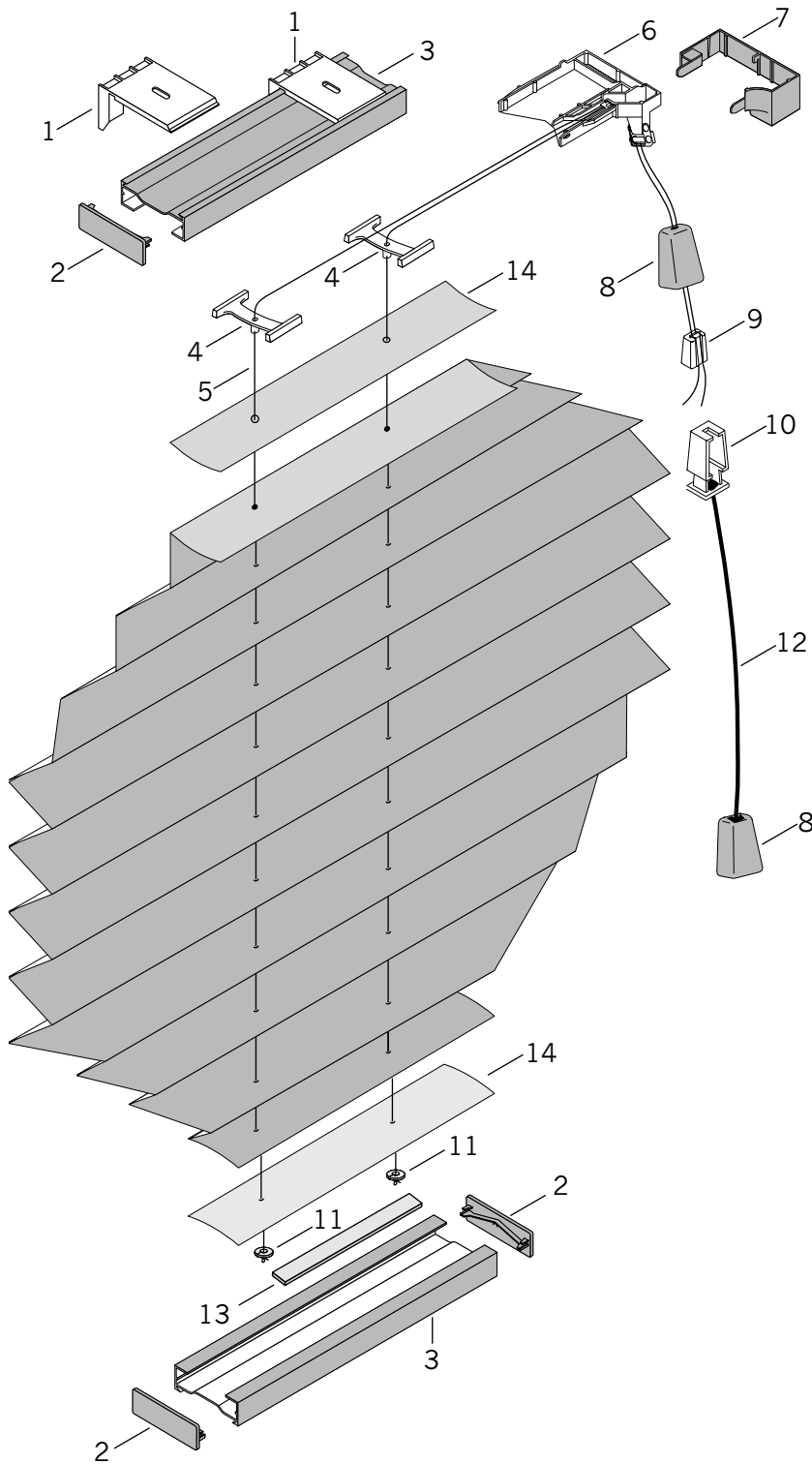

## Standard Parts

1. Installation Brackets
2. End Caps
3. Headrail/Bottomrail
4. Cord Guide
5. Lift Cord
6. Cordlock Body
7. Cordlock Cover
8. Universal Cover/Tassel
9. Cord Equalizer
10. Equalizer Housing
11. Plastic Washer
12. Pull Cord
13. Rail Weight
14. Filler Strip

# Specialty Shades

<b>No.</b>	<b>PCN</b>	<b>Description</b>
1.		Installation Brackets
	PC555255	Installation Bracket - White (2 Pack)
	PC555256	Installation Bracket - White (3 Pack)
2.		Headrail/Bottomrail Endcaps
	5570xx	
	2950020xxx	
3.	2950010xxx	Headrail/Bottomrail
4.	558000	Cord Guide
5.		0.9 mm Lift Cord
	5580xx	
	PC5580xx	
6.		Cordlock Body
	2950095000	Left Hand
	2950094000	Right Hand
7.		Cordlock Cover – Left Hand
	5560xx	
	2950085xxx	
		Cordlock Cover – Right Hand
	5560xx	
	2950075xxx	
8.	2930440xxx	Universal Cover/Tassel
9.	559058	Cord Equalizer
10.	2930561000	Equalizer Housing
11.	555019	Plastic Washers
12.		1.8 mm Pull Cord
	5580xx	
	PC5580xx	
	WWC5580xx	
13.		Rail Weight - Optional (*used only if needed)
	PC5550003	
	PC5550006	
	PC55500012	
14.	2954000000	Filler Strip

## **Additional Components:**

XSB101A72P	Room Darkening Backing
XTW101A90P	Light Filtering Backing
2980246000	Child Safety Kit
LIT888005	Speciality Installation Instructions (English)
LIT888005F	Speciality Installation Instructions (French)
555004	Installation Screw
444956	Extension Brackets
5007311000	Hold-Down Bracket
2930230000	Spacer Block
555065	Tape
888105	Bottomrail Label (English)
7106858000	Bottomrail Label (French)
7107684000	Cord Stop Safety Hang Tag

xxx = Color Code