

Motorized (HD228A)

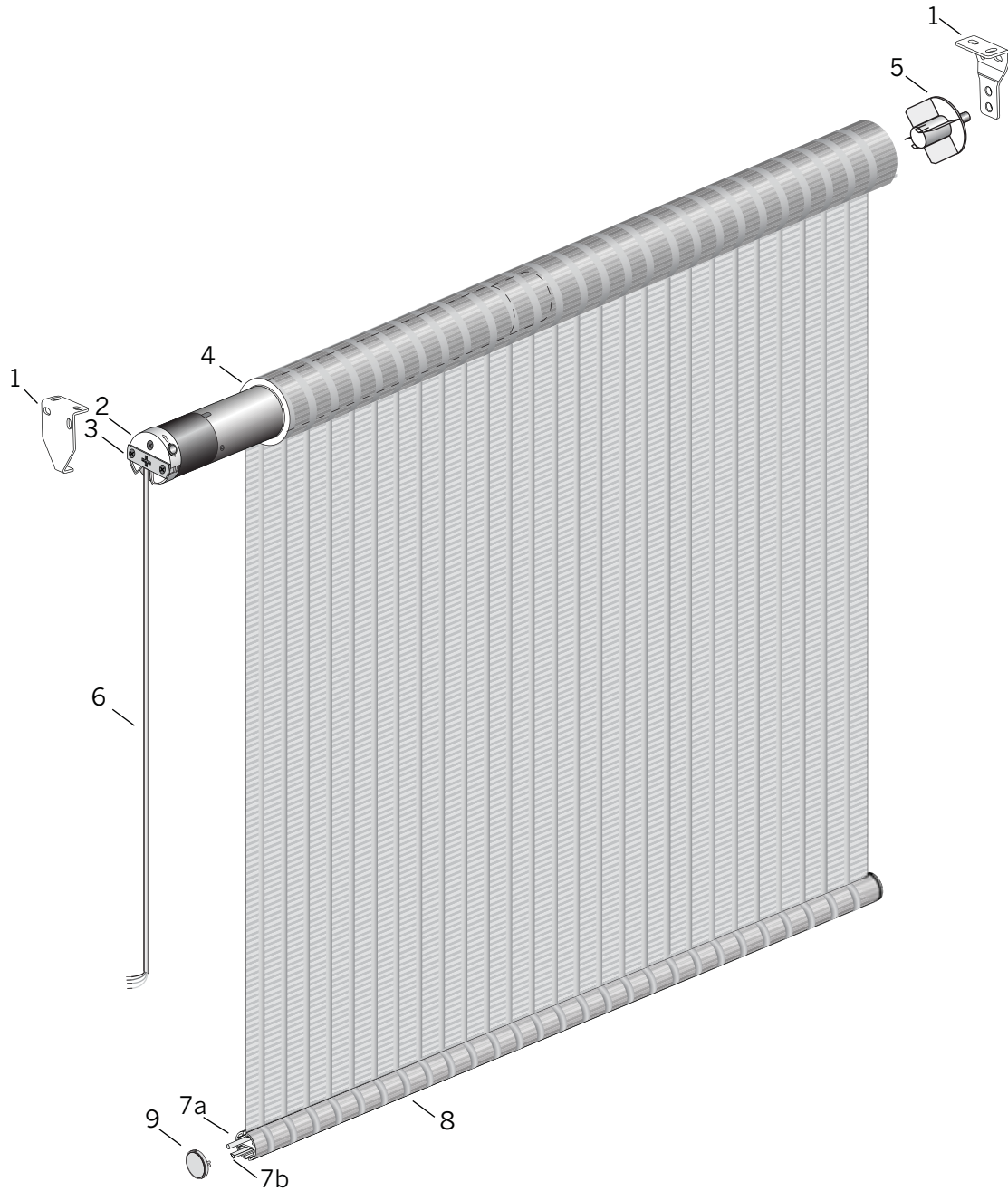

Standard Parts

- | | | |
|----------------------|----------------------------------|--------------------------------|
| 1. Mounting Brackets | 5. Spring Pin End Assembly | 8. Round Bottom Bar |
| 2. Motor | 6. Power Cord | 9. Plastic Bottom Bar End Caps |
| 3. 228 Motor Bracket | 7a. Small Or Large Round Profile | |
| 4. Tube | 7b. Triangle Profile | |

Motorized (HD228A)

No.	PCN	Description	Installation Instructions / Labels / Hang Tags:
1.	RC138000	2" Installation Bracket Kit (R3/R8 with Spring End), 228 Motor, Zinc	LIT888245C Quiet Motorized Roller (Standard and Cassette) IOC (English Installation Instructions)
2.	RC445146	Motor HD228A	
3.	RC445161	228 Motor Bracket	LIT888245CF Quiet Motorized Roller (Standard and Cassette) IOC (French Installation Instructions)
4.	RC445304L192	16' Roller Tube For 228 Motor	
5.	RC445306	Assembly Kit-Spring Pin End & Crown & Drive Set (Not Shown)	
6.	N/A	Power Cord (Supplied With Motor)	LIT888094 "Do Not Remove" wrap (used as outer wrap on finished shades)
7a.	RC445085	Small Round Profile (For Thicker Fabrics)	888105 Bottom Bar Warning Sticker (English/Spanish)
	RC445086	Large Round Profile (For Thinner Fabrics)	7106858000 Bottom Bar Warning Sticker (English/French)
7b.	RC445087	Triangle Profile	
8.	RC418xxx	Round Bottom Bar	
9.	RC414xxx	Plastic Bottom Bar End Caps	xxx = Color Code

Shade Options (Upgrades):

Decorative Metal End Caps (For Bottom Bar)

- RC416xxx Beveled
- RC415xxx Flat

Faux Wood Slats

- RC445323 Double Faced Adhesive For Faux Wood Slat And Designer Tape Trims
- RC420xxx Faux Wood Slats
- LIT888248 Faux Wood Slat Label

Upgrades for Designer Roller Shades

- RC403xxx Grosgrain Tape Trim
- RC404xxx Grosgrain Stripe Tape Trim
- RC407xxx Herringbone Tape Trim
- RC406xxx Petite Gimp Trim
- 445040 Glue for Petite Gimp Trim

Upgrade for Designer Screen Shades

- RC445340 Sealed Hem Bar