

Shutter Panel — Front Tilt

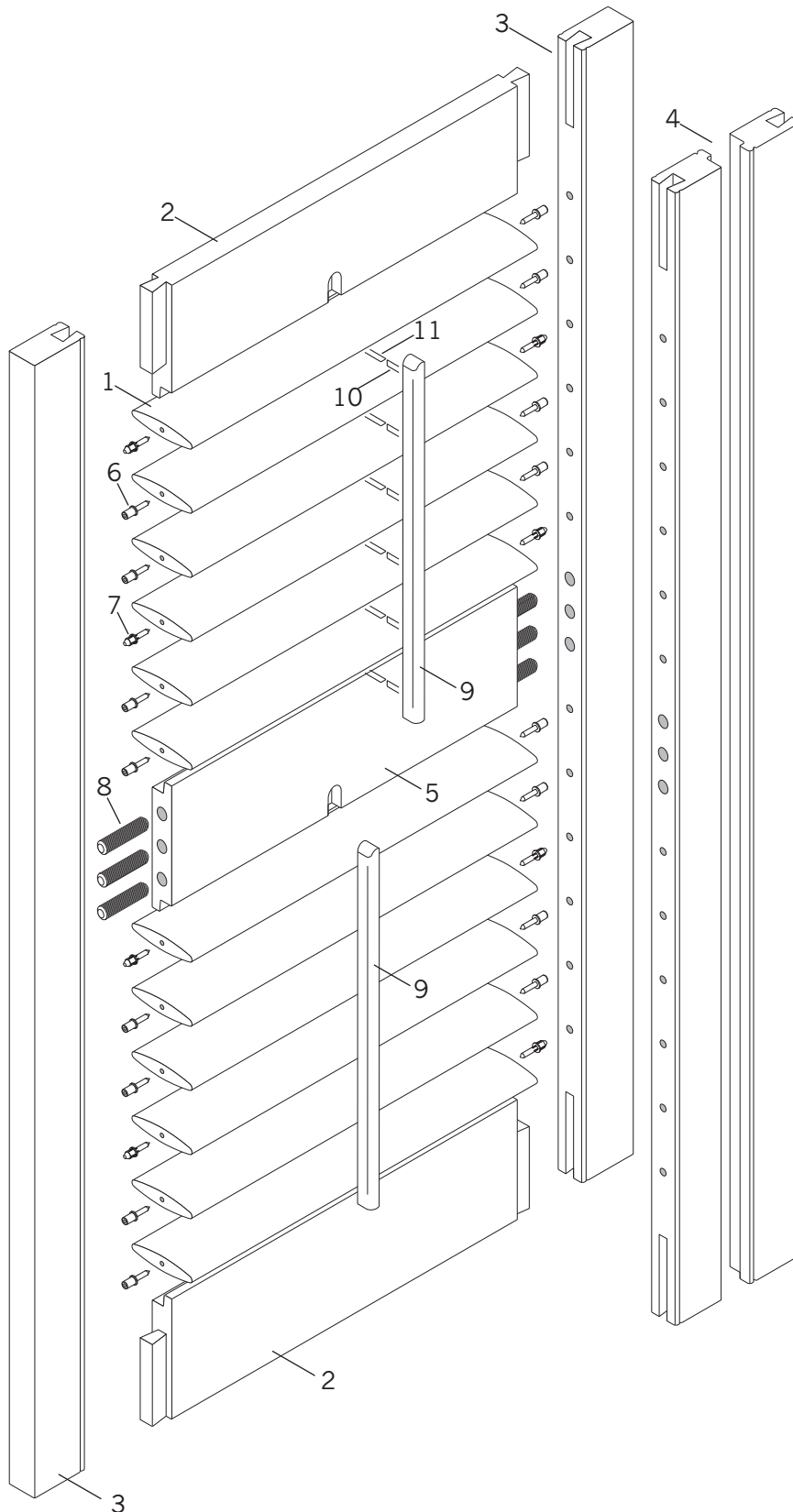

Standard Parts

1. Louver
2. Top/Bottom Rail – Up Closure
- 2a. Top/Bottom Rail – Up/Down Closure
3. Stiles
4. Rabbeted Stiles
5. Divider Rail – Up Closure
- 5a. Divider Rail – Up/Down Closure
6. Louver Pin
7. Louver Tension Pin
8. Dowel
9. Tilt Bar
10. Staples – Tilt Bar
11. Staples – Louver

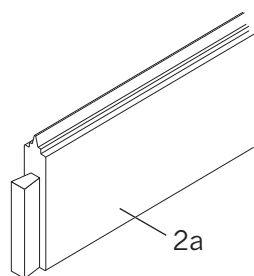
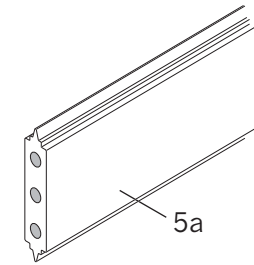

Shutter Panel — Front Tilt

No.	PCN	Description	Component Colors	
1.	MSL01xxx	2.5" Louver	608	Eggshell
	MSL02xxx	3.5" Louver	609	Linen
	MSL03xxx	4.5" Louver	650	Pure White
2.	MSR06xxx	Top/Bottom Rail – Up Closure	651	Soft White
			652	Warm Cream
2a.	MSR07xxx	Top/Bottom Rail – Up/Down Closure	653	Cameo White
			659	Golden Oak
3.	MSS01xxx	Rectangular Stile 2.5"	670	Warm Cherry
	MSS03xxx	Rectangular Stile 3.5"	671	Amaretto
	MSS05xxx	Rectangular Stile – Non-drilled	672	Bahama Brown
	MSS07xxx	Rectangular Stile 4.5"	Hinge Colors	
4.	MSS02xxx	Rabbeted Stile 2.5"	006	Brass Finish
	MSS04xxx	Rabbeted Stile 3.5"	007	Antique Brass Finish
	MSS06xxx	Rabbeted Stile – Non-drilled	008	Brushed Nickel Finish
	MSS08xxx	Rabbeted Stile 4.5"	009	White
5.	MSR01xxx	Divider Rail 2.5"/4.5" – Up Closure	010	Off-White
			011	Stainless Steel
	MSR03xxx	Divider Rail 3.5" – Up Closure	012	Butter Cup
5a.	MSR08xxx	Divider Rail 2.5"/4.5" – Up/Down Closure	022	Venetian Bronze
			023	Satin Black
	MSR09xxx	Divider Rail 3.5" – Up/Down Closure		
6.	WHP01001	Louver Pin		
7.	WHP02003	Louver Tension Pin		
8.	WHD01000	Dowel 10 mm x 50 mm		
9.	MST01xxx	Tilt Bar		
10.	WHS01001	Galvanized Staples ¼" Crown x ⅝" – Tilt Bar		
11.	MHS02001	Galvanized Staples ⅜" Crown x 1" – Louver		

xxx = 3-digit color code