

End Controls

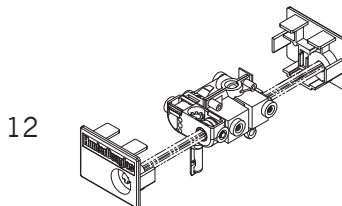
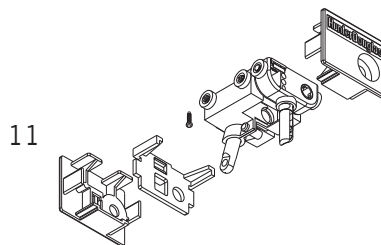
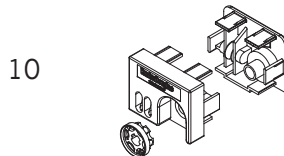
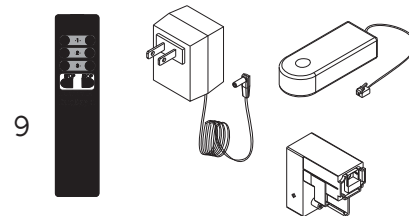
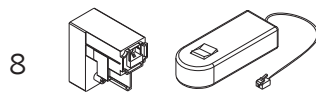
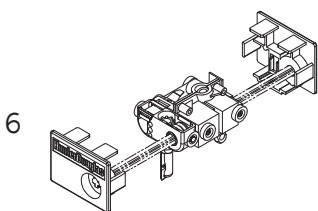
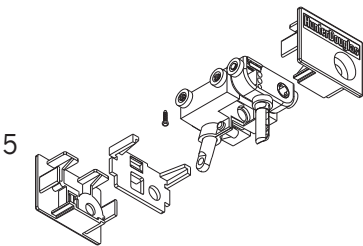
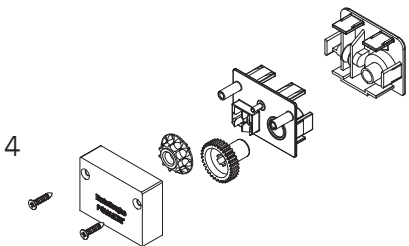
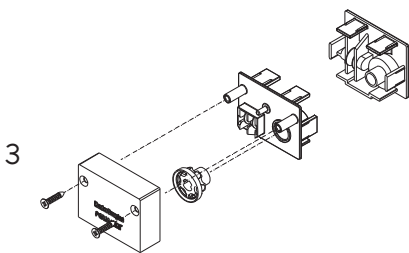
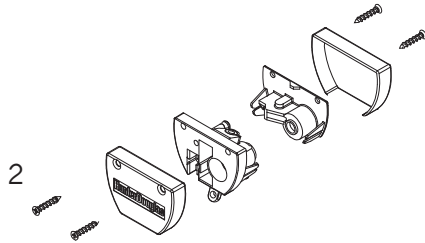
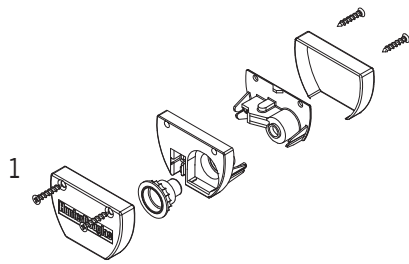

Standard Parts

Paramount®

1. Standard End Control Assembly
2. PermaTilt® End Control Assembly

PermaAlign®

3. #6 Direct Drive End Control Assembly ^{w/}Cover
4. #10 Gear-Reduced End Control Assembly
5. PermaAssure® Wand Control ^{w/}Rod Support
6. PermaAssure® Wand Control Assembly Center Draw
7. Screw For Gear-Reduced Cover

PermaAlign® & PermaTrak®

8. Motorized Tilt Switch Unit
9. Motorized Tilt Remote Control Unit

PermaTrak®

10. PermaTrak End Control Assembly
11. Wand Control Assembly ^{w/}Rod Support
12. Wand Control Assembly Center Draw

End Controls

No. PCN	Description
Paramount®	
1. 7700800	Standard End Control Assembly (200 Pieces)
2. 7700810	PermaTilt® End Control Assembly (200 Pieces)
PermAlign®	
3. 96816	#6 Direct Drive End Control Assembly w/Cover – Ivory (200 Pieces)
4. #10 Gear-Reduced End Control Assembly (200 Pieces)	
PD0684	Grey
7705800	Bronze
IPD0684	Ivory
5. IWCU0501	PermaAssure® Wand Control w/Rod Support – Ivory (10 Pieces)
6. IWCU0502	PermaAssure® Wand Control Assembly Center Draw – Ivory (10 Pieces)
7. PD-0685	Screw For Gear-Reduced Cover (100 Pieces)
PermAlign® & PermaTrak®	
8. MHD1000000	Motorized Tilt Switch Unit (1 EA)
9. MHD2000000	Motorized Tilt Remote Control Unit (1 EA)
PermaTrak®	
10. 7702803	End Control Assembly – Grey (200 Pieces)
11. WCU0501	PermaAssure® Wand Control Assembly w/Rod Support – Grey (10 Pieces)
12. WCU0502	PermaAssure® Wand Control Assembly Center Draw – Grey (10 Pieces)