

# Center Draw

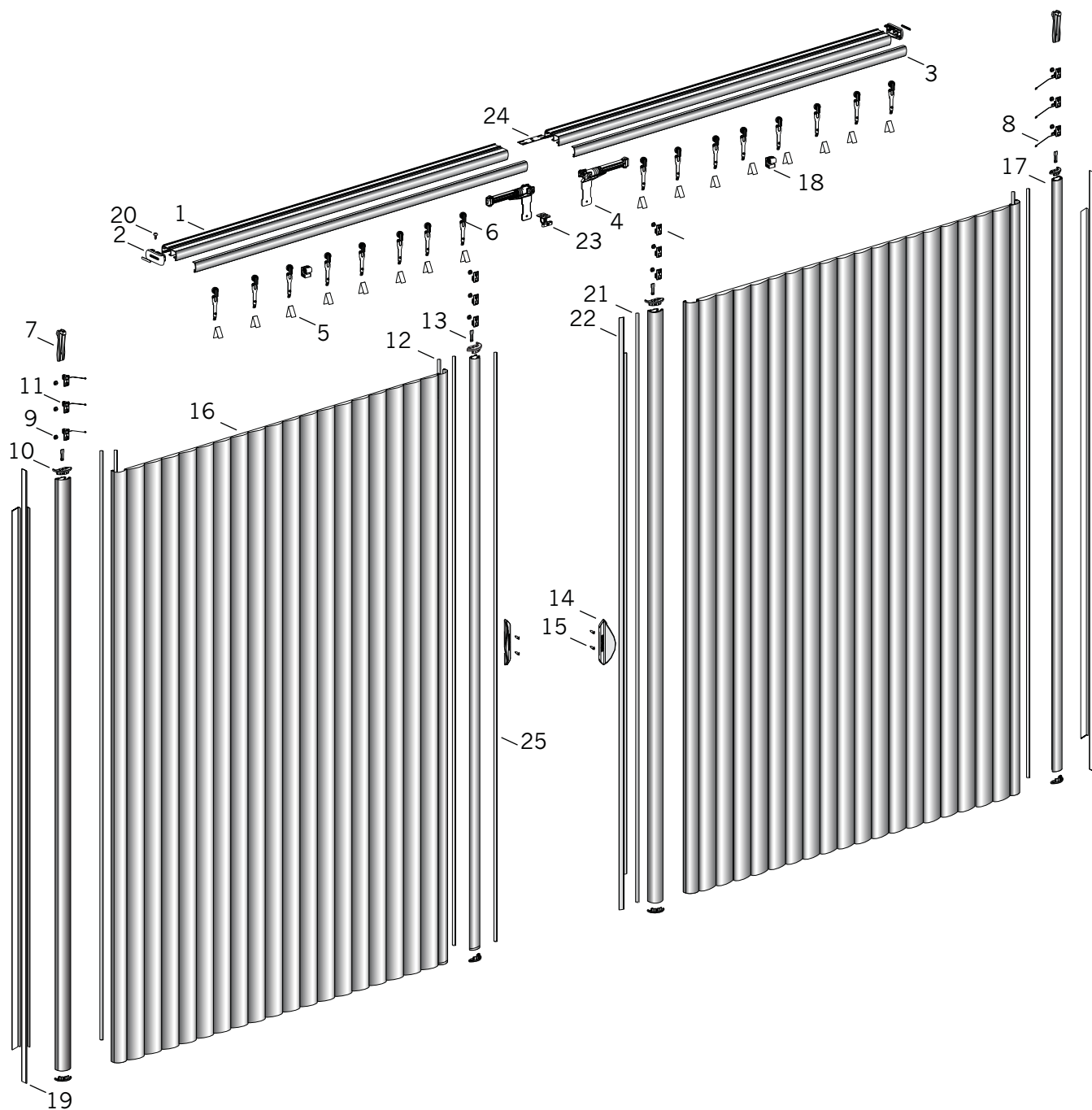

## Standard Parts

- |                                |                                |                               |
|--------------------------------|--------------------------------|-------------------------------|
| 1. Headrail                    | 9. Spring Holder, Pivot Lock   | 17. Vertical Rail             |
| 2. Headrail End Cap Set        | 10. Vertical Rail End Cap Set  | 18. Cord Anchor               |
| 3. Headrail Fabric Cover       | 11. Cord Guide                 | 19. Return (Optional)         |
| 4. Trike Assembly              | 12. Edge-to-Edge Poly Strip    | 20. Screw                     |
| 5. Fabric Reinforcer           | 13. Snap Lock                  | 21. Magnetic Latch            |
| 6. Fabric Clip Roller Assembly | 14. Handle Kit                 | 22. Center Draw Overlap       |
| 7. Stationary Rail Hanger.     | 15. Screw, WS FLH PHH 6 X 0.5" | 23. Center Draw Stop Plate    |
| 8. Ultra Wear Cord 0.9 mm      | 16. Fabric                     | 24. Center Draw Joining Plate |
|                                |                                | 25. Magnetic Latch            |

# Center Draw

<b>No.</b>	<b>PCN</b>	<b>Description</b>
1.	3400186661	Headrail
2.	3400294XXX	Headrail End Cap Set
3.	N/A	Headrail Fabric Cover
4.	3400187000	Trike Assembly
5.	3402800000	Fabric Reinforcer
6.	3400185000	Fabric Clip Roller Assembly
7.	3400257000	Stationary Rail Hanger.
8.	2675000000	Ultra Wear Cord 0.9 mm
9.	2981043000	Spring Holder, Pivot Lock
10.	3400292XXX	Vertical Rail End Cap Set
11.	3400220000	Cord Guide
12.	4150288785	Edge-to-Edge Poly Strip
13.	3400275000	Snap Lock
14.	3403500XXX	Handle Kit
15.	3400203000	Screw, WS FLH PHH 6 X 0.5"
16.	N/A	Fabric
17.	3400212661	Vertical Rail
18.	3401217000	Cord Anchor
19.	TBD	Return (Optional)
20.	3400191000	Screw
21.	1003000281	Magnetic Latch
22.	1003000251	Center Draw Overlap
23.	1003000181	Center Draw Stop Plate
24.	1003000180	Center Draw Joining Plate
25.	Magnetic Latch	
	3400281000	Side A
	3400306000	Side B

XXX = Color Code