

Side Stack

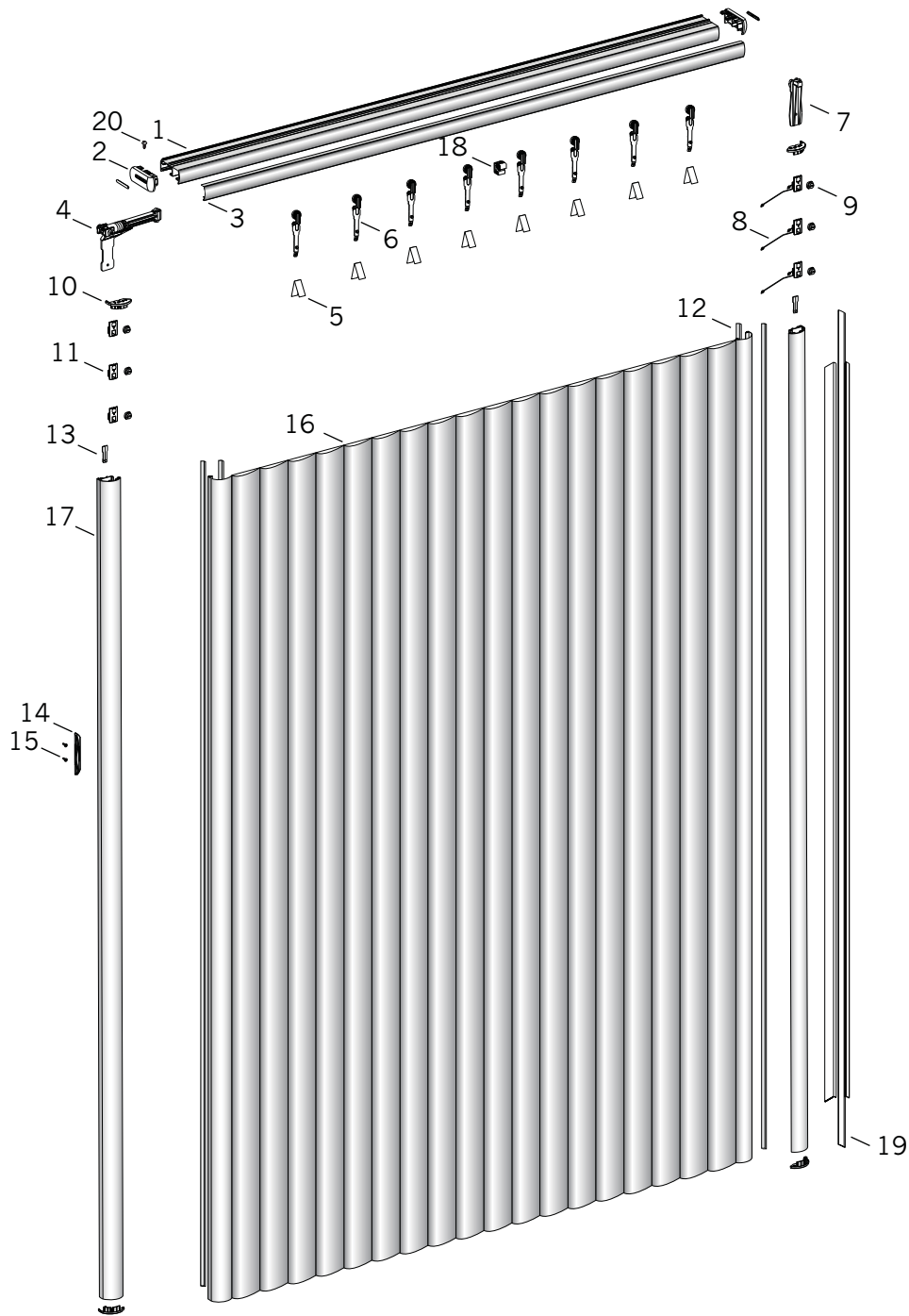

Standard Parts

- | | | |
|--------------------------------|-------------------------------|-----------------------|
| 1. Headrail | 8. Ultra Wear Cord | 15. Screw, #6 X 0.5" |
| 2. Headrail End Cap Set | 9. Spring Holder, Pivot Lock | 16. Fabric |
| 3. Headrail Fabric Cover | 10. Vertical Rail End Cap Set | 17. Vertical Rail |
| 4. Trike Assembly | 11. Cord Guide | 18. Cord Anchor |
| 5. Fabric Reinforcer | 12. Edge-to-Edge Poly Strip | 19. Return (Optional) |
| 6. Fabric Clip Roller Assembly | 13. Snap Lock | 20. Screw |
| 7. Stationary Rail Hanger | 14. Handle Kit | |

Side Stack

No.	PCN	Description
1.	3400186661	Headrail
2.	3400294XXX	Headrail End Cap Set
3.	N/A	Headrail Fabric Cover
4.	3400187000	Trike Assembly
5.	3402800000	Fabric Reinforcer
6.	3400185000	Fabric Clip Roller Assembly
7.	3400257000	Stationary Rail Hanger.
8.	2675000000	Ultra Wear Cord 0.9 mm
9.	2981043000	Spring Holder, Pivot Lock
10.	3400292XXX	Vertical Rail End Cap Set
11.	3400220000	Cord Guide
12.	4150288785	Edge-to-Edge Poly Strip
13.	3400275000	Snap Lock
14.	3403500XXX	Handle Kit
15.	3400203000	Screw, WS FLH PHH 6 X 0.5"
16.	N/A	Fabric
17.	3400212661	Vertical Rail
18.	3401217000	Cord Anchor
19.	TBD	Return (Optional)
20.	3400191000	Screw

XXX = Color Code