



kirsch®

Ambiance™ Sheers with Room Darkening

Suggested Retail Pricing
Effective April 2015

Table of Contents

Overview

How to Place an Order	3
How to Measure	4
Critical Dimensions	5-6
Light Control Index	6
Finish Index	7
Cleaning Guide	7

Pricing

Price Group H - Voile	8
Price Group I - Linen and Satinage	9
Price Group J - Boucle Sheer	10

Product Guide

Features and Benefits	11
Options and Upgrades	11-12
Replacement Headrails	13
Fabric by the Yard	13
Vane Count and Stacking Chart	14
Replacement Vane Packs	15
Exploded View - Cordless Wand Control	16
Exploded View - Cord/Chain Control	17
Terms and Conditions	18
Kirsch Trust Warranty	19

How to Place an Order

STEP 1 General Shade Information

Color Number
Color Description

STEP 2 Stack Options

One Way, Right or Left
Dual Stack
Center Stack
Reverse Stack (available on cord/chain only)

STEP 3 Options and Upgrades

The following options may be available. See individual price page information for detailed availability.

Cordless Wand Control
Cord/Chain Control
BackStacker®
Valance Upgrade
Extension Brackets

STEP 4 Mount Type and Shade Measurement

See page 4 for measurement instructions.

Inside or Outside Mount
WIDTH first, then HEIGHT

STEP 5 Quantity of Shades Being Ordered

STEP 6 Delivery Information

Indicate ship to address

STEP 7 Purchase Order Number

How to Measure

NOTE: Smallest unit of measure is $\frac{1}{8}$ ". Shades installed on windows near wall or baseboard heaters must clear the heaters by 12" above and 6" to the side.

Inside Mount (IM) Installation - Patio Doors and Windows

To find width: Measure the opening across the top where the headrail is to be installed from inside of window frame on left to inside of window frame on right. Round the measurement down to the nearest $\frac{1}{8}$ ". A minimum depth of $2\frac{7}{8}$ " is needed to install inside the patio door or window.

To find height: Measure from the inside top of the opening on the left, at the center, and on the right to the sill; round the measurement down to the nearest $\frac{1}{8}$ " and note the smallest dimension. Do not make any allowances: the factory will make all adjustments so the headrail will fit the opening properly and the vanes will clear the sill by $\frac{1}{4}$ " to $\frac{1}{2}$ ".

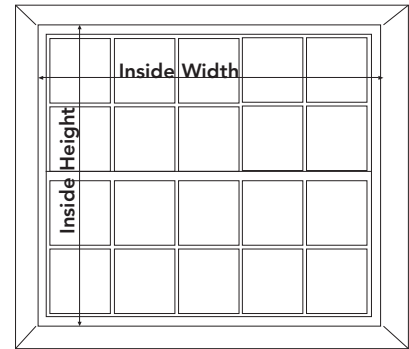

Outside Mount (OM) Installation - Windows

To find width: Measure the width of the area to be covered at the place where the headrail will be installed to the nearest $\frac{1}{8}$ ". Shade should overlap opening at least 4" on each side to ensure privacy. To maintain the maximum view, allow adequate overlap, and consider the stack width. To calculate stack dimensions, consult the Vane Count and Stacking Chart on page 14.

To find height: Measure the height of the area to be covered and round down to the nearest $\frac{1}{8}$ ". Shade should extend at least 3" above and 3" below opening or window frame. For installations ceiling to the floor, make adequate allowance for carpeting. Specifying OM measurement means the factory makes no allowances.

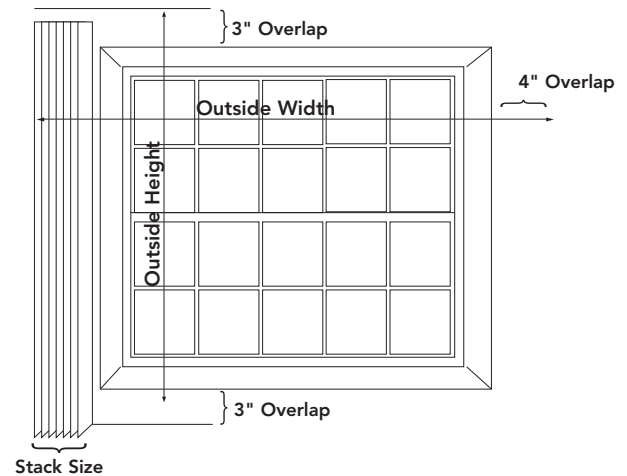

Outside Mount (OM) Installation - Patio Doors

To find width: Measure the width of the area to be covered at the place where the headrail will be installed to the nearest $\frac{1}{8}$ ". Shade should overlap opening at least 4" on each side to ensure privacy. To ensure easy access through the door and allow adequate overlap, consider the stack width. To calculate stack dimensions, consult the Vane Count and Stacking Chart on page 14.

To find height: Measure the height of the area to be covered and round down to the nearest $\frac{1}{8}$ ". Shade should extend at least 3" above opening or window frame. For installations ceiling to the floor, deduct $\frac{1}{2}$ " for proper clearance. Specifying OM measurement means the factory makes no allowances.

NOTE: Outside Mount installation with required overlaps on top and side of window/door will minimize light gaps and provide better room darkening for Ambiance™ Room Darkening Sheers compared to inside mount option.

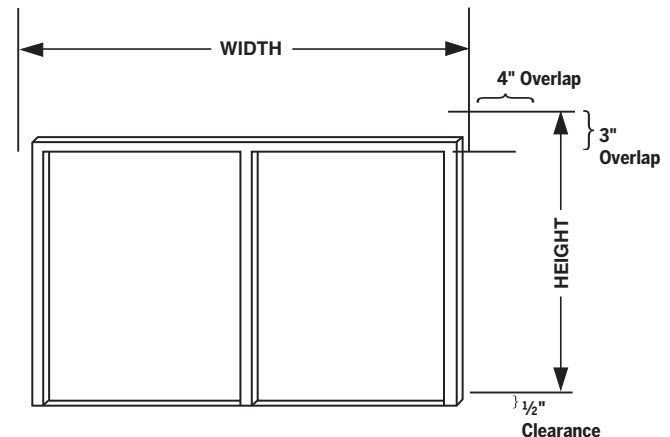

Extension Brackets - Extends from 2" to 4"

Recommended for outside mount only when an obstruction protrudes beyond the window, such as window cranks and other mechanisms. Extension brackets are adjustable. Must request at time of order. See pages 16-17 for part number.

Critical Dimensions

HEADRAIL DIMENSIONS AND INSTALLATION DEPTH REQUIREMENTS

Headrail is 1 $\frac{1}{8}$ " deep x 1 $\frac{1}{2}$ " high.

Minimum Depth to Install (Headrail will protrude)	Inside Mount	2 $\frac{7}{8}$ "
Flush Mount Headrail	Inside Mount	3 $\frac{1}{2}$ "
Flush Mount Vanes and Fabric Folds (Pleats)	Inside Mount	6 $\frac{1}{4}$ "
Flush Mount Channel Valance	Inside Mount	4 $\frac{1}{8}$ "
Flush Mount Fabric Wrap Valance	Inside Mount	5 $\frac{1}{2}$ "
Minimum Clearance from Wall/Window to Headrail	Inside and Outside Mount	2 $\frac{3}{4}$ "

ESTATE™ VALANCE CLEARANCE FOR OUTSIDE MOUNT

The Estate Valance with finial requires 7" of clearance for the finial past each end of the headrail or 1 $\frac{1}{2}$ " of clearance for the End Cap finial past each end of the headrail.

*Estate Valances are available on Outside Mount only.

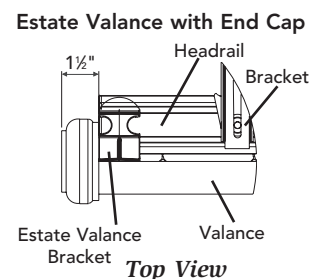
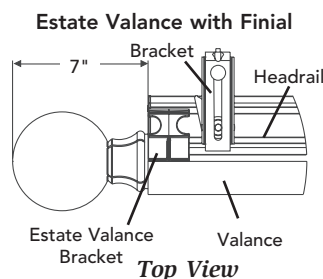

SIZE LIMITATIONS

	One Way Minimum Width	Dual Stack Minimum Width	Center Stack Minimum Width	One Way, Dual, and Center Stacks Maximum Width	Minimum Height	Maximum Height
Inside Mount (IM)	13 $\frac{3}{8}$ "	25 $\frac{7}{8}$ "	48"	144"	12"	144"
Outside Mount (OM)	13 $\frac{3}{8}$ "	25 $\frac{7}{8}$ "	48"	144"	12"	144"

FACTORY DEDUCTIONS*

	Inside Mount	Outside Mount
Headrail	$\cdot\frac{1}{4}$ "	0"
Fabric	$\cdot\frac{1}{4}$ "	0"

* An extra 5/8" deduction on the vane length will be taken when an inside mount with a fabric valance is ordered.

OUTSIDE MOUNT VALANCE RETURN MEASUREMENT

Standard valance return is 2 $\frac{3}{4}$ ". If a longer return is needed, measure the inside return length of the valance as shown and provide measurement. See page 12 for minimum and maximum valance return length as well as other valance measurements.

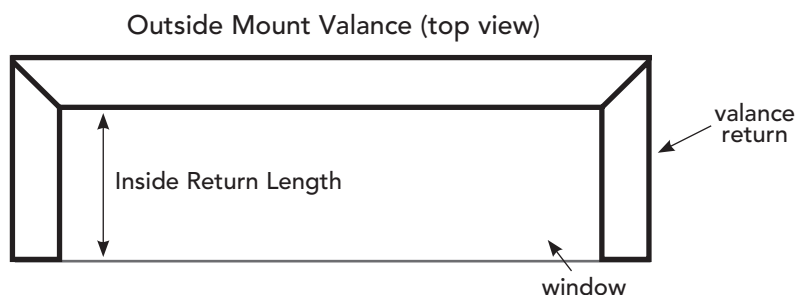

Critical Dimensions

CONTROL LENGTH

Shade Height	Cordless Wand Length*
18" - 24"	12"
24 1/8" - 36"	20"
36 1/8" - 96"	33"
96 1/8" - 108"	47"
108 1/8" - 120"	59"
120 1/8" - 132"	69"
132 1/8" - 144"	80"

*Length of cordless wand is from top of headrail.

Shade Height	Cord Length
Less than 19"	12"
19 1/8" - 96"	7" less than total length
Over 96"	90"

Tilt chain is standard 42" unless otherwise specified.

INSTALLATION BRACKETS AND VALANCE CLIPS

Included with Shade.

Shade Width	Number of Brackets	Number of Valance Clips
Up to 36"	3	3
36 1/8" to 66"	4	4
66 1/8" to 96"	5	5
96 1/8" to 126"	6	6
126 1/8" to 144"	7	7

HEM SIZE

Top Hem	2"
Bottom Hem	1"

Light Control Index

Each collection is rated for light control. This convenient indicator can be found next to the Available Colors grid on each pricing page.

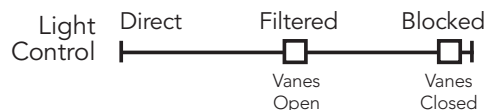

NOTE: For enhanced light control and privacy, utilize Outside Mount installation with required top (3") and side (4") overlap. See page 4 for Outside Mount requirements.

Finish Index

PRICE GROUP H

Voile Collection

Color #	Description
---------	-------------

60132161	Snow
60132101	Whisper
60132104	Tumbleweed

PRICE GROUP I

Linen Collection

Color #	Description
---------	-------------

60431501	Whisper
60431502	Cream
60431514	Sand
60431518	Sterling
60431510	Everglade
60431505	Mink
60431508	Toffee
60431506	Dijon
60431511	Terra Cotta
60431513	Chili Spice
60431517	Sangria
60431520	Espresso

PRICE GROUP J

Boucle Sheer Collection

Color #	Description
---------	-------------

60332361	Snow
60332302	Cream
60332325	Daylight

Satinage Collection

Color #	Description
---------	-------------

60532461	Snow
60535001	Whisper
60535002	Cream
60532424	Daylight
60535003	Candlelight
60532404	Tumbleweed
60535104	Sand
60532418	Sterling
60532419	Sage
60535073	Everglade
60532405	Mink
60532408	Toffee
60535070	Dijon
60532417	Sangria
60535071	Chili Spice
60535072	Mocha
60532420	Espresso
60532415	Slate
60532447	Black

Cleaning Guide

Routine care of Ambiance® Sheers with Room Darkening will allow the shade to provide elegance and versatility for years of enjoyment.



Routine Maintenance

Periodic dusting will keep the shade looking clean and new. For many shades this will be the only cleaning required.



Stain Removal

Should the shade become soiled, it may be necessary to spot clean. Gently dab the stain with lukewarm water and add a mild detergent if needed. Careful blotting of the fabric should avoid creasing or wrinkling. With any detergent solution, always test for colorfastness on an inconspicuous area.



Heavier Cleaning

Occasionally it might be necessary to remove excess dust accumulation by using the soft brush attachment of a vacuum cleaner.

The suggested cleaning instructions must be followed to maintain the lifetime limited warranty.

Ambiance™ Sheers with Room Darkening

Price Group H

Voile Collection

PRICE GROUP H

Width to	25 7/8"	38 3/8"	50 7/8"	63 3/8"	75 7/8"	85 1/4"	88 3/8"	100 7/8"	113 3/8"	125 7/8"	138 3/8"	144"
Height to 48"	328	442	525	602	688	746	765	873	970	1,069	1,154	1,195
60"	358	486	573	669	765	832	854	974	1,084	1,198	1,292	1,337
72"	390	537	638	740	857	935	961	1,093	1,220	1,351	1,462	1,515
84"	414	572	681	790	902	1,000	1,029	1,169	1,304	1,447	1,563	1,619
96"	506	627	744	861	981	1,069	1,098	1,239	1,383	1,535	1,660	1,722
108"	577	722	866	1,008	1,155	1,264	1,298	1,447	1,641	1,825	1,978	2,052
120"	597	751	902	1,054	1,208	1,323	1,359	1,516	1,701	1,914	2,075	2,154
132"	624	785	945	1,103	1,268	1,385	1,426	1,590	1,786	1,985	2,177	2,259
144"	648	816	984	1,150	1,320	1,447	1,487	1,659	1,861	2,074	2,247	2,337

Surcharge Options

Channel Valance (replacement)	12	17	22	30	36	37	42	72	80	85	89	95
Fabric Valance	14	18	22	25	29	31	33	37	42	47	52	56
Estate™ Valance	119	129	149	165	178	184	189	198	212	218	228	236
BackStacker®	21	31	42	52	62	74	75	84	95	105	115	126

Channel valance comes standard at no additional charge.

*Color must be specified. See page 12 for available colors.

FREE OPTIONS

- Channel Valance (Standard)
- Cordless Wand Control (Standard)
- Cord/Chain Control
- One Way Stack, Left or Right
- Extension Brackets

See pages 11-12 for descriptions and images on all options.

SURCHARGE OPTIONS

ADD TO THE PRICE OF THE BLIND:

Valance Upgrades	See Price Grid
BackStacker®*	See Price Grid
Dual Stack	\$113
Center Stack	\$113
Reverse Stack*	\$113

*Available with cord/chain control only.

AVAILABLE COLORS - VOILE COLLECTION

Snow	60132161	Whisper	60132101	Tumbleweed	60132104
------	----------	---------	----------	------------	----------

Ambiance™ Sheers with Room Darkening

Price Group I

Linen and Satinage Collections

PRICE GROUP I

Width to	25 7/8"	38 3/8"	50 7/8"	63 3/8"	75 7/8"	85 1/4"	88 3/8"	100 7/8"	113 3/8"	125 7/8"	138 3/8"	144"
Height to 48"	490	602	717	825	943	1,024	1,052	1,200	1,335	1,477	1,592	1,649
60"	539	667	790	925	1,058	1,154	1,186	1,348	1,506	1,664	1,800	1,864
72"	592	739	882	1,029	1,194	1,303	1,340	1,524	1,705	1,890	2,047	2,122
84"	633	792	948	1,108	1,268	1,404	1,442	1,639	1,835	2,035	2,205	2,286
96"	698	872	1,042	1,210	1,383	1,509	1,552	1,751	1,960	2,177	2,358	2,446
108"	792	1,000	1,207	1,413	1,621	1,776	1,827	2,039	2,315	2,577	2,794	2,904
120"	828	1,048	1,267	1,484	1,707	1,871	1,924	2,152	2,416	2,718	2,948	3,062
132"	867	1,103	1,331	1,562	1,796	1,971	2,027	2,266	2,546	2,833	3,106	3,228
144"	902	1,149	1,392	1,635	1,880	2,064	2,124	2,374	2,668	2,973	3,228	3,355

Surcharge Options

Channel Valance (replacement)	12	17	22	30	36	37	42	72	80	85	89	95
Fabric Valance	18	23	27	31	36	40	42	47	51	59	66	70
Estate™ Valance	119	129	149	165	178	184	189	198	212	218	228	236
BackStacker®	21	31	42	52	62	74	75	84	95	105	115	126

Channel valance comes standard at no additional charge.

*Color must be specified. See page 12 for available colors.

FREE OPTIONS

- Channel Valance (Standard)
- Cordless Wand Control (Standard)
- Cord/Chain Control
- One Way Stack, Left or Right
- Extension Brackets

SURCHARGE OPTIONS

ADD TO THE PRICE OF THE BLIND:

Valance Upgrades	See Price Grid
BackStacker®*	See Price Grid
Dual Stack	\$113
Center Stack	\$113
Reverse Stack*	\$113

See pages 11-12 for descriptions and images on all options.

*Available with cord/chain control only.

AVAILABLE COLORS - LINEN COLLECTION

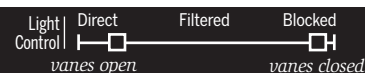

Whisper	60431501	Everglade	60431510	Terra Cotta	60431511
Cream	60431502	Mink	60431505	Chili Spice	60431513
Sand	60431514	Toffee	60431508	Sangria	60431517
Sterling	60431518	Dijon	60431506	Espresso	60431520

AVAILABLE COLORS - SATINAGE COLLECTION

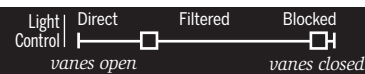

Snow	60532461	Sterling	60532418	Chili Spice	60535071
Whisper	60535001	Sage	60532419	Mocha	60535072
Cream	60535002	Everglade	60535073	Espresso	60532420
Daylight	60532424	Mink	60532405	Slate	60532415
Candlelight	60535003	Toffee	60532408	Black	60532447
Tumbleweed	60532404	Dijon	60535070		
Sand	60535104	Sangria	60532417		

Ambiance™ Sheers with Room Darkening

Price Group J

Boucle Sheer Collection

PRICE GROUP J

Width to	25 7/8"	38 3/8"	50 7/8"	63 3/8"	75 7/8"	85 1/4"	88 3/8"	100 7/8"	113 3/8"	125 7/8"	138 3/8"	144"
Height to 48"	589	721	858	989	1,132	1,228	1,264	1,440	1,604	1,771	1,913	1,981
60"	647	799	948	1,109	1,271	1,385	1,423	1,618	1,805	1,997	2,161	2,237
72"	710	887	1,058	1,234	1,433	1,565	1,609	1,829	2,047	2,268	2,455	2,545
84"	760	952	1,139	1,328	1,523	1,685	1,732	1,967	2,202	2,443	2,646	2,745
96"	837	1,046	1,248	1,453	1,660	1,812	1,864	2,102	2,352	2,612	2,831	2,936
108"	952	1,201	1,449	1,695	1,947	2,133	2,195	2,449	2,778	3,092	3,355	3,484
120"	994	1,258	1,522	1,782	2,049	2,245	2,310	2,581	2,900	3,261	3,540	3,674
132"	1,042	1,324	1,598	1,874	2,158	2,364	2,433	2,720	3,056	3,401	3,730	3,874
144"	1,084	1,379	1,669	1,962	2,257	2,476	2,550	2,848	3,204	3,568	3,874	4,026

Surcharge Options

Channel Valance (replacement)	12	17	22	30	36	37	42	72	80	85	89	95
Fabric Valance	22	27	35	37	45	47	51	57	62	71	80	85
Estate™ Valance	119	129	149	165	178	184	189	198	212	218	228	236
BackStacker®	21	31	42	52	62	74	75	84	95	105	115	126

Channel valance comes standard at no additional charge.

*Color must be specified. See page 12 for available colors.

FREE OPTIONS

- Channel Valance (Standard)
- Cordless Wand Control (Standard)
- Cord/Chain Control
- One Way Stack, Left or Right
- Extension Brackets

SURCHARGE OPTIONS

ADD TO THE PRICE OF THE BLIND:

Valance Upgrades	See Price Grid
BackStacker®*	See Price Grid
Dual Stack	\$113
Center Stack	\$113
Reverse Stack*	\$113

See pages 11-12 for descriptions and images on all options.

*Available with cord/chain control only.

AVAILABLE COLORS - BOUCLE SHEER COLLECTION

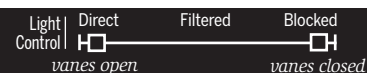

Snow	60332361	Cream	60332302	Daylight	60332325
------	----------	-------	----------	----------	----------

Features and Benefits

LIGHT CONTROL

Kirsch presents a beautiful window covering that functions as a light filtering drapery and a room darkening blind all in one. Perfect for adding ambiance to formal rooms or casual settings, Kirsch Ambiance Sheers with Room Darkening are the most versatile window covering for any décor. Choose fabric, valance and control options that fit any room.



Light Filtering

Fabrics filter light when vanes are open



Room Darkening

Vanes block light when vanes are rotated closed

Options and Upgrades

CORDLESS WAND CONTROL - STANDARD

Cordless Wand Control eliminates dangling cords and chains, providing safe and smooth operation.

- One-control convenience - vanes are rotated and traversed with the wand
 - Streamlined appearance
 - Increases safety
 - Sizes listed on page 6
 - Available in styles and finishes below
- Not available with BackStacker® feature*



CORDED CONTROL - OPTION



- Available at no charge
- Required for BackStacker®
- Standard cord color is Ivory
- Standard tilt chain color is Silver

Wand Finishes

Wand Styles	White	Off White	Satin Nickel	Bronze
Traditional	67171	67172	67174	67176
Transitional	67271	67272	67274	67276

CONTROL AND STACK OPTIONS

NOTE: Wand control follows stack position



One Way Right Stack
For corded operation, controls on right



One Way Left Stack
For corded operation, controls on left



Dual Stack
controls on left or right



Center Stack
For corded operation, controls on left or right
For Wand Control, wand on left and right
Not available with BackStacker



Reverse Stack
either direction
Left Stack, Controls Right or
Right Stack, Controls Left
Not available with Wand Control

Ambiance™ Sheers with Room Darkening

BACKSTACKER® OPERATING SYSTEM

With Ambiance standard operating system, the fabric stacks in front of the window. With Kirsch exclusive BackStacker on Ambiance Sheers with Room Darkening, the fabric stacks neatly on the outer edge of the window, preserving the view and enhancing the enjoyment of the natural scenery. BackStacker extends the life of your shade by reducing pull on the draw cord. You will achieve optimum functionality with one way stack, dual stack and reverse stack options. BackStacker is not available with center stack option or cordless wand control.

Standard Operating System

vanes collect in the middle of the window



Ambiance™ with BackStacker®

vanes collect at side of window providing an uninterrupted view



STANDARD CHANNEL VALANCE

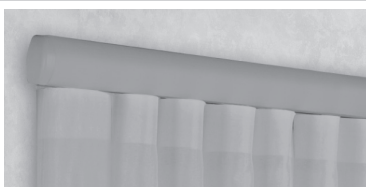

	Height	Depth	Min Return	Max Return	Std Return
Channel Valance	1 3/8"	5/8"	2"	6"	2 3/4"

Valance returns only available on outside mount installation option.

- Comes standard on each shade at no charge.
- Valance color coordinates to fabric color.

UPGRADES

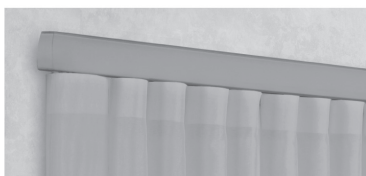

	Height	Depth	Min Return	Max Return	Std Return
Fabric Valance	2"	1/2"	2"	6"	2 3/4"

Valance returns only available on outside mount installation option.

Fabric valance upgrade

- Valance color coordinates to fabric color.

— Estate™ Collection —



Estate™ End Cap upgrade

- Available for Outside Mount only.
- Available with End Cap or a variety of finials.
- See clearance requirements on page 5.

	Height	Depth
Estate™ Valance	2"	1"

Estate collection valance colors:

White

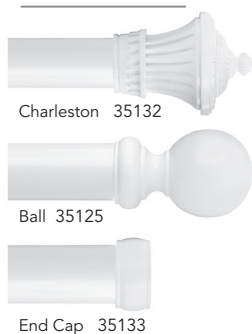

Oak

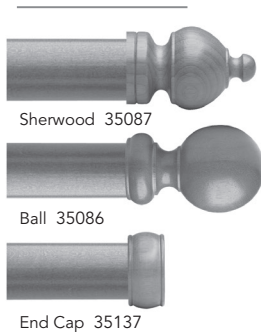

Walnut

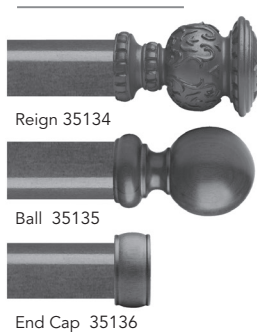

Mahogany



Sandblasted Black

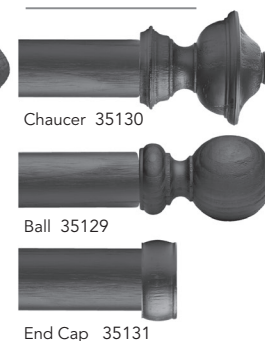

Replacement Headrails

Specify width and length plus type of installation.

Width to	25½"	38½"	50½"	63½"	75½"	85½"	88½"	100½"	113½"	125½"	138½"	144"
Standard Headrail	135	172	203	239	271	295	307	343	375	411	443	479
BackStacker® Headrail	184	242	302	363	417	466	483	538	593	651	713	768

Fabric by the Yard (3 Yard Minimum Order)

All Ambiance fabrics are sold by the yard for easy coordination within a room. Add color and flair to windows by dressing them with your own unique touch. Note: Scarf treatments cannot be used with the Estate™ Valance.

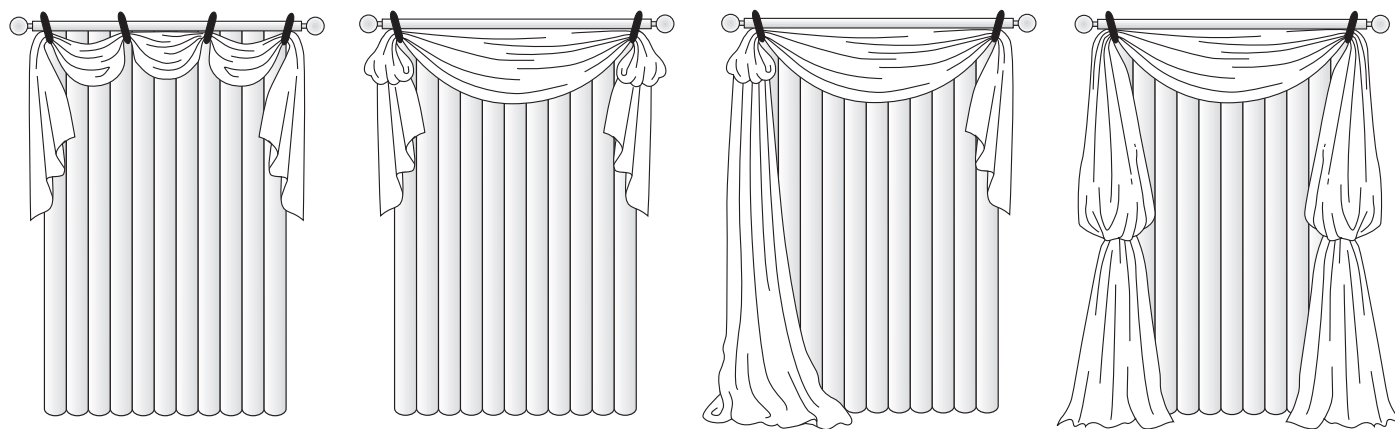

Order your hardware separately. We recommend Kirsch® drapery hardware.

FABRIC BY THE YARD (3 YARD MINIMUM ORDER)		FABRIC WIDTH
Voile	\$11 per yard	72"
Linen	\$20 per yard	68"
Satinage	\$20 per yard	72"
Boucle Sheer	\$49 per yard	55"

Vane Count and Stacking Chart

SHADE WIDTH	One Way Stack			Dual Stack		
	NO. OF VANES	STACK WIDTH	CLEAR OPENING*	NO. OF VANES	STACK WIDTH	CLEAR OPENING*
13½"	4	3⅞"	9¼"	---	---	---
16¼"	5	4⅞"	12⅞"	---	---	---
19⅞"	6	4½"	15"	---	---	---
22½"	7	4¾"	17¾"	---	---	---
25⅞"	8	5⅞"	20½"	8	3⅞"	18"
28¾"	9	5½"	23¼"	---	---	---
31⅞"	10	5¾"	26"	10	4⅞"	23⅞"
35"	11	6⅞"	28⅞"	---	---	---
38⅞"	12	6½"	31⅞"	12	4½"	29"
41¼"	13	6¾"	34½"	---	---	---
44⅞"	14	7⅞"	37¼"	14	4¾"	34¾"
47½"	15	7½"	40"	---	---	---
50⅞"	16	7¾"	42¾"	16	5¼"	40⅞"
53¼"	17	8⅞"	45⅞"	---	---	---
56⅞"	18	8½"	48⅞"	18	5½"	46"
60"	19	8¾"	51¼"	---	---	---
63⅞"	20	9⅞"	54"	20	5¾"	51½"
66¼"	21	9⅞"	56⅞"	---	---	---
69⅞"	22	9¾"	59⅞"	22	6⅞"	57"
72½"	23	10⅞"	62⅞"	---	---	---
75⅞"	24	10⅞"	65¼"	24	6½"	62¼"
78¾"	25	10¾"	68"	---	---	---
81⅞"	26	11⅞"	70¾"	26	6¾"	68¼"
85"	27	11⅞"	73½"	---	---	---
88⅞"	28	11¾"	76⅞"	28	7⅞"	74"
91¼"	29	12⅞"	79⅞"	---	---	---
94⅞"	30	12⅞"	82"	30	7½"	79½"
97½"	31	12¾"	84¾"	---	---	---
100⅞"	32	13"	87⅞"	32	7¾"	85⅞"
103¼"	33	13⅞"	90¼"	---	---	---
106⅞"	34	13¾"	93"	34	8"	90⅞"
110"	35	14"	96"	---	---	---
113¼"	36	14⅞"	98¾"	36	8½"	96¼"
116¼"	37	14¾"	101½"	---	---	---
119⅞"	38	15"	104⅞"	38	8¾"	101⅞"
122½"	39	15⅞"	107⅞"	---	---	---
125⅞"	40	15¾"	110"	40	9⅞"	107⅞"
128⅞"	41	16"	112¼"	---	---	---
131⅞"	42	16⅞"	115½"	42	9⅞"	113"
135"	43	16¾"	118⅞"	---	---	---
138⅞"	44	17"	121"	44	9¾"	118⅞"
141¼"	45	17⅞"	123⅞"	---	---	---
144"	46	17⅞"	126½"	46	10"	124¼"

How To Use The Chart:

1. Select stack type

- One Way
- Dual

2. Select appropriate clear opening width

3. Order shade width in far left column

Note: Dual stack requires even number of vanes

*Clear opening chart is for outside mount only.

*For center stack, use one way stack column.

Replacement Vane Packs

Replacement vane packs may be ordered to replace damaged vanes or for a decorating change. Easily update your window decor by simply switching your current vane pack with a new vane pack. When ordering, indicate the style of shade and the width and height needed, including headrail.

Note: There is no guarantee of color match to the original order.

PRICE GROUP H - VOILE

Width to	25 7/8"	38 3/8"	50 7/8"	63 3/8"	75 7/8"	85 1/4"	88 3/8"	100 7/8"	113 3/8"	125 7/8"	138 3/8"	144"
Height to 48"	281	380	452	519	592	642	657	751	834	920	992	1,028
60"	311	422	500	583	667	724	744	848	941	1,040	1,125	1,164
72"	343	472	563	652	756	823	847	961	1,073	1,189	1,286	1,332
84"	368	509	607	704	804	891	915	1,039	1,161	1,286	1,392	1,440
96"	456	564	671	776	882	961	989	1,115	1,245	1,380	1,493	1,550
108"	524	656	787	917	1,051	1,150	1,181	1,317	1,493	1,660	1,800	1,869
120"	550	693	832	969	1,113	1,218	1,252	1,395	1,565	1,762	1,908	1,982
132"	582	732	878	1,028	1,179	1,289	1,327	1,479	1,659	1,846	2,023	2,102
144"	608	768	925	1,082	1,243	1,357	1,399	1,560	1,750	1,948	2,113	2,196

* Add Dual Stack or Center Stack Surcharge of \$113, if applicable.

PRICE GROUP I - LINEN AND SATINAGE

Width to	25 7/8"	38 3/8"	50 7/8"	63 3/8"	75 7/8"	85 1/4"	88 3/8"	100 7/8"	113 3/8"	125 7/8"	138 3/8"	144"
Height to 48"	427	523	623	717	823	892	916	1,044	1,162	1,283	1,385	1,435
60"	473	586	695	813	934	1,014	1,044	1,186	1,324	1,466	1,585	1,640
72"	528	657	787	915	1,063	1,160	1,194	1,357	1,516	1,683	1,820	1,888
84"	569	714	854	996	1,141	1,263	1,298	1,477	1,653	1,831	1,983	2,058
96"	638	792	946	1,098	1,258	1,374	1,413	1,592	1,785	1,980	2,144	2,228
108"	729	921	1,112	1,301	1,492	1,635	1,683	1,877	2,130	2,371	2,572	2,671
120"	769	976	1,179	1,380	1,587	1,739	1,790	2,000	2,246	2,526	2,741	2,848
132"	816	1,038	1,252	1,468	1,688	1,851	1,906	2,128	2,393	2,664	2,921	3,036
144"	858	1,091	1,322	1,553	1,787	1,961	2,021	2,255	2,534	2,824	3,067	3,188

* Add Dual Stack or Center Stack Surcharge of \$113, if applicable.

PRICE GROUP J - BOUCLE SHEER

Width to	25 7/8"	38 3/8"	50 7/8"	63 3/8"	75 7/8"	85 1/4"	88 3/8"	100 7/8"	113 3/8"	125 7/8"	138 3/8"	144"
Height to 48"	511	628	748	861	985	1,071	1,098	1,253	1,395	1,542	1,664	1,723
60"	569	704	833	976	1,118	1,219	1,252	1,424	1,591	1,759	1,900	1,968
72"	633	788	944	1,097	1,274	1,392	1,431	1,630	1,820	2,019	2,185	2,265
84"	684	856	1,024	1,195	1,370	1,515	1,559	1,771	1,983	2,199	2,382	2,470
96"	764	952	1,137	1,318	1,511	1,649	1,695	1,913	2,141	2,377	2,574	2,674
108"	876	1,107	1,333	1,562	1,791	1,962	2,019	2,254	2,557	2,845	3,086	3,207
120"	921	1,171	1,414	1,658	1,904	2,088	2,148	2,398	2,696	3,033	3,292	3,420
132"	980	1,244	1,503	1,762	2,027	2,221	2,289	2,554	2,870	3,198	3,507	3,644
144"	1,030	1,308	1,587	1,864	2,144	2,354	2,423	2,705	3,042	3,389	3,683	3,824

* Add Dual Stack or Center Stack Surcharge of \$113, if applicable.

Exploded View - Cordless Wand Control

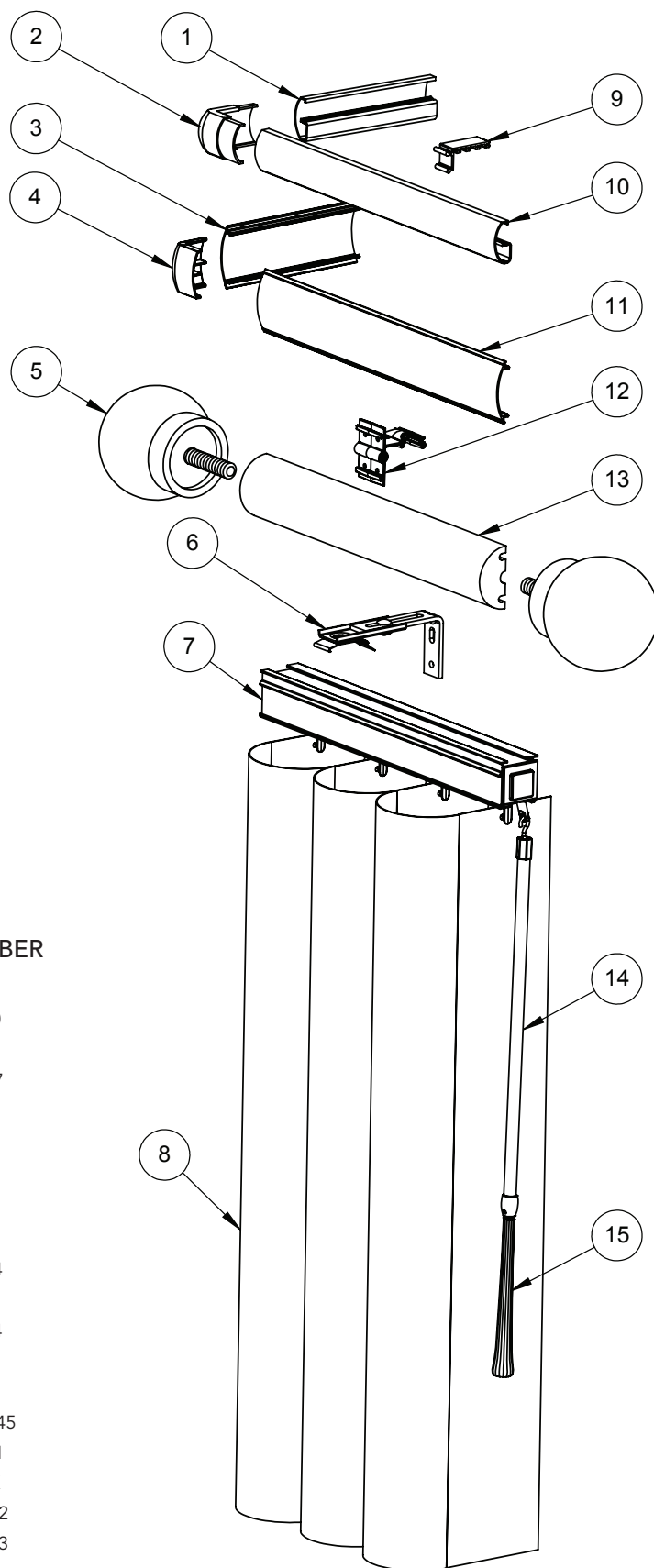

PART DESCRIPTION

1	Channel Valance Return	V27S0000
2	Channel Valance Corner	V17C0000
3	Fabric Valance Return	SD144005
4	Fabric Valance Corner	HBCK0067
5	Estate™ Valance Finial	---
6	Installation Bracket	---
	Outside Mount	905400LC
	Inside Mount	905300LC
	Extension Bracket*	905450LC
7	Headrail	RAHR0054
8	Vane Pack	---
9	Channel Valance Bracket	HFCEP0044
10	Channel Valance	V27S0000
11	Fabric Valance	SD150005
12	Estate And Fabric Valance Bracket	HFCEP0046/45
13	Estate Valance Fascia	PD0206-01
14	Wand Rod	RPLE007X
15	Traditional Handle	HGWN0022
	Transitional Handle *	HGWN0023

* = Not Pictured

Exploded View - Cord/Chain Control

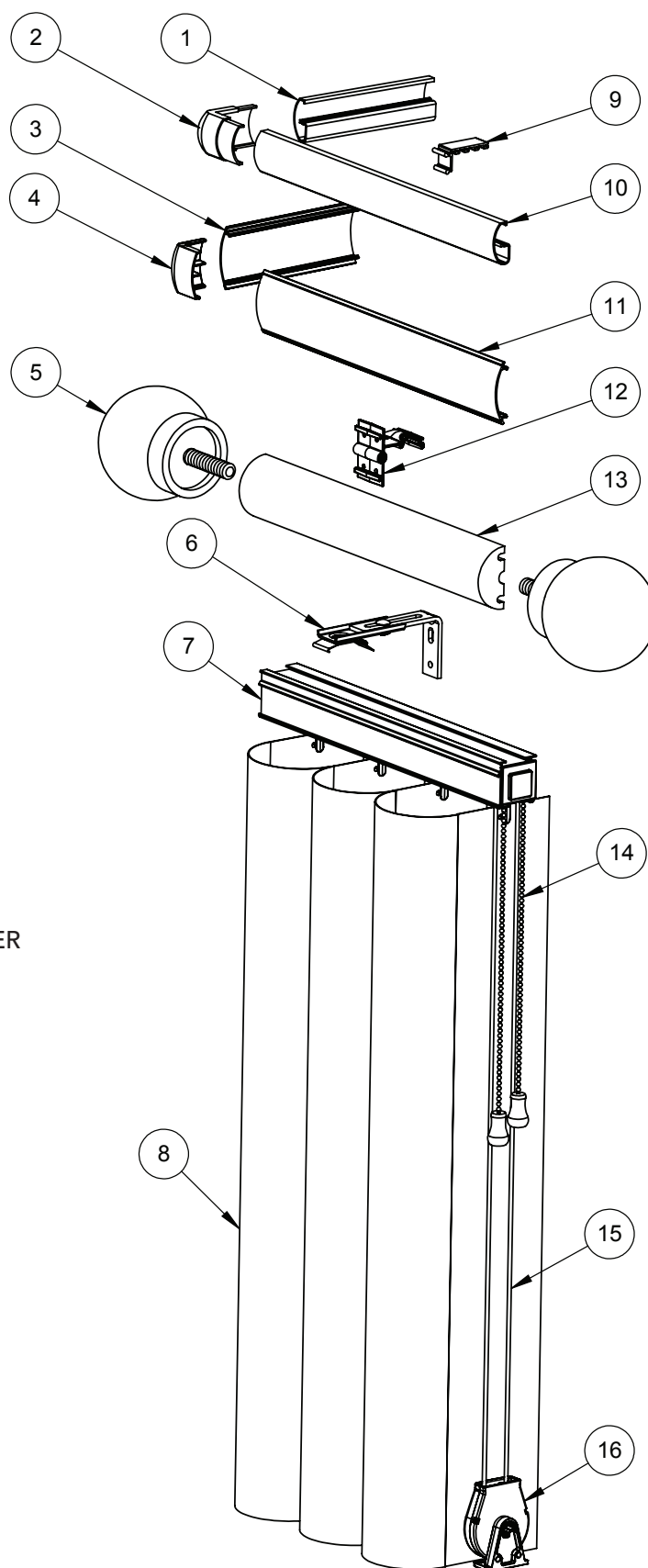

PART DESCRIPTION

PART NUMBER

1	Channel Valance Return	V27S0000
2	Channel Valance Corner	V17C0000
3	Fabric Valance Return	SD144005
4	Fabric Valance Corner	HBCK0067
5	Estate Valance Finial	---
6	Installation Bracket	---
	Outside Mount	905400LC
	Inside Mount	905300LC
	Extension Bracket*	905450LC
7	Headrail	RAHR0054
8	Vane Pack	---
9	Channel Valance Bracket	PDM82861
10	Channel Valance	V27S0000
11	Fabric Valance	SD150005
12	Estate And Fabric Valance Bracket	HFCEP0046/45
13	Estate Valance Fascia	PD0206-01
14	Chain - Rotates Vanes	DDW80199
15	Cord - Traverse Vanes	DUL83801
16	Cord Tension Device	HGTS0018

* = Not Pictured

Terms and Conditions

Order Processing

Telephone Orders

Verbal orders are accepted as the dealer's responsibility. Each order will be repeated back by the Customer Service Representative. In certain instances, we may require written orders.

Duplicated Orders

All orders are confirmed after entry into our system. Customer Service is not responsible for duplicate orders caused by a written order following a telephone order or duplicate faxes.

Changes and Cancellations

All products are custom-made to your specifications under tight deadlines. Once production has begun on your order, changes and cancellations cannot be made.

Contract Orders

All Contract Orders must be processed through Contract Customer Service at 1-800-826-8021.

Freight

- Shipments outside the continental U.S. are subject to freight charges.
- Chargeable parts and returns for repair are subject to freight charges.

Pricing and Terms

All prices are subject to change without notice. Until credit is approved, terms are cash with order. Standard terms are Net 30 days from invoice date.

Claims and Returns

Defective Merchandise

All manufacturing defects must be reported to Customer Service within 30 days of receipt of blinds. We may require the return of defective blinds prior to repair or replacement.

Incorrect Merchandise

If any part of your shipment was made incorrectly, please advise Customer Service within 30 days. A replacement will be made at no charge if the problem was due to Kirsch® error. If the problem was due to dealer or customer error, the original order and replacement order will be full charge.

Returns for Repair

Prior to return for repair, contact Customer Service. We will request the order number, date, purchase order number, and type of product. Arrangements for return will be made at that time with directions as to how the blinds should be returned. The package should be marked for easy identification both inside and outside, and should contain a written confirmation of the verbal repair instructions. Repairs should be packaged carefully. Product that has been mishandled or received in poor condition will be returned to the customer.

Chargebacks for unauthorized repairs or additional installation cannot be honored. All returns for repair are subject to freight charges.

Returns for Credit

Returns can be accepted only if prior authorization has been obtained from Customer Service. Authorization will include instructions as to how the merchandise should be returned. Unauthorized returns will be refused.

Freight Damage FedEx/FedEx Ground:

- If freight damage is visible, refuse the shipment. FedEx will inspect the damage and return to the shipping location. Contact Customer Service for further information.
- If freight damage is concealed, retain all packaging materials and contact Customer Service immediately (must be notified within 14 days).

Freight Damage Common Carrier:

- If freight damage is visible, refuse the shipment. The carrier will return the merchandise to the shipping location for inspection. Contact Customer Service for further information.
- If freight damage is concealed, retain all packaging materials and contact Customer Service immediately (must be notified within 14 days).

the kirsch[®] TRUST[™]

RISK-FREE EXCHANGE &
FULL 10-YEAR WARRANTY

At Kirsch, we're committed to making products and relationships that last. That's why we offer a product with a complete warranty and a no-risk exchange policy.

No Risk Exchange Policy

Whether you mis-measured or simply changed your mind, if you don't love your custom Kirsch for any reason, we'll exchange it within 30 days of receipt.

Full 10-year Warranty

Your investment will last. If any part of your custom Kirsch breaks or is damaged due to poor workmanship or defect within 10 years of purchase, we'll repair or replace it free of charge.

kirsch®



kirsch.com

Kirsch Window Fashions ©2015
3 Glenlake Parkway, Atlanta, GA 30328
1-800-225-1988 • 1-800-545-2325 fax • www.kirsch.com

A ***Newell Rubbermaid***™ Brand



1939126